

World Class Performance  
in Abrasive, Scaling and  
Corrosive Slurries, Sludge,  
Liquids, and Bulk Solids

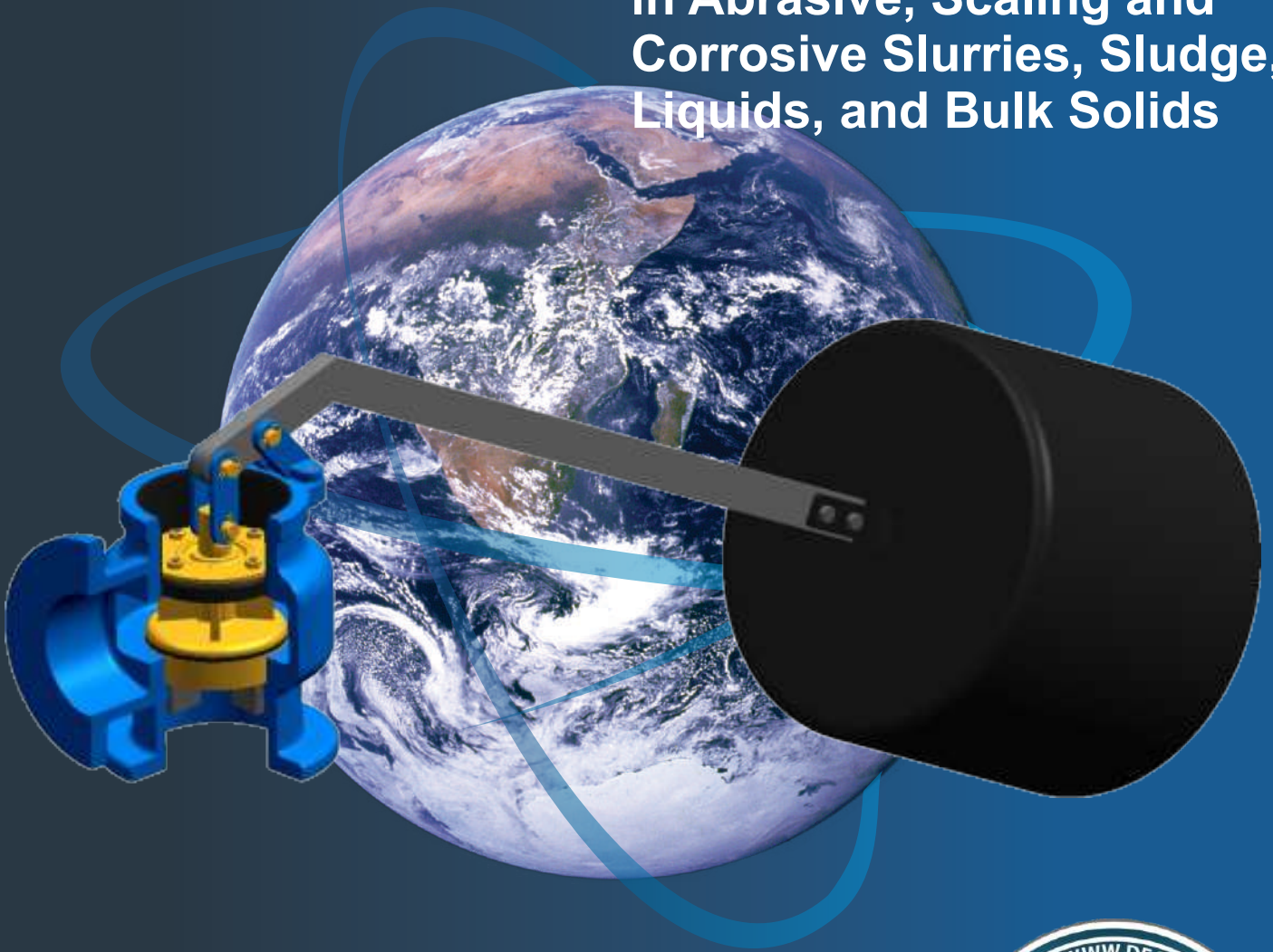

# ***EQUILIBRIUM FLOAT VLVE SERIES 7354***



## Series 7354 Equilibrium Float Valves

### VOSA Equilibrium Float Valve Design

Equilibrium (ball) float valves are mechanical float valves used to automatically control the levels in tanks and reservoirs. These valves are particularly suited for level control in gravity mains of short to moderate lengths.

The VOSA Equilibrium Float Valve design has a relatively long actuating lever, providing for a long float travel to ensure a slow rate of valve closure and a reduction of induced pressure rises within the main.

### Pressure Ratings

Valve Size DN	Seat Press. Rating	Body Press. Rating	Flange Rating PN	Fig. No.
50 - 200	10 bar	16 bar	10 bar	7354

### Overall Dimensions and Weights

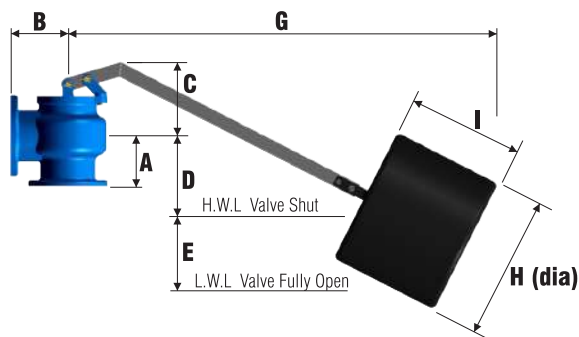

DIMENSIONS (mm)									
SIZE mm	A	B	C	D	E	G	H	I	WEIGHT (kg)
50	105	89	130	140	255	1135	300	300	13
80	124	102	167	152	295	1350	350	350	22
100	146	140	220	190	365	1450	350	350	36
150	178	203	254	254	550	1530	500	400	74
200	184	241	340	210	610	1630	500	400	110

### Materials of Construction

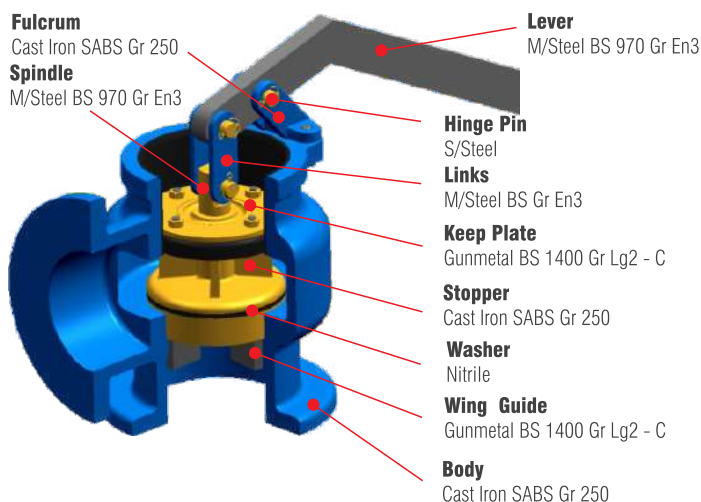

### Sizing Nomogram

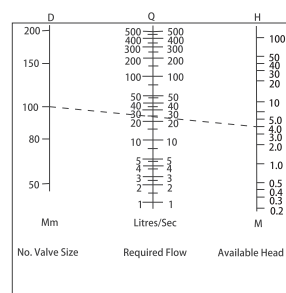

Basic Formula:

$$D = 29.4 \sqrt{\frac{Q}{H}}$$

Recommended maximum capacity based on 3 m/s pipe velocity:

Size DN	Flow litres/sec
50	6
80	14
100	24
150	55

The Chart involves 3 factors:

1. Valve bore (D) in mm
2. Available pressure (H) in metres head. This is the dynamic head available.
3. Maximum Flow in (Q) in litres per second.

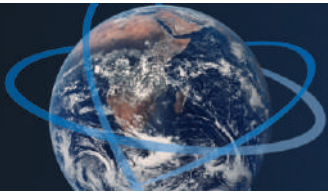

## Direct Acting Float Valves

### Figure 7342

The Vosa Figure 7342 series valve is a stainless steel direct acting float actuated level control valve. The plunger and float arm has a direct mechanical linkage with a spring to assist valve opening and to reduce any water hammer that may occur from an unsteady surface. The length of the float arm can be altered if required.

This valve is available in sizes 40mm and 50mm with a maximum pressure rating of 2000 kPa. The nitrile seat can withstand a maximum temperature of 80°C.

### Materials of Construction

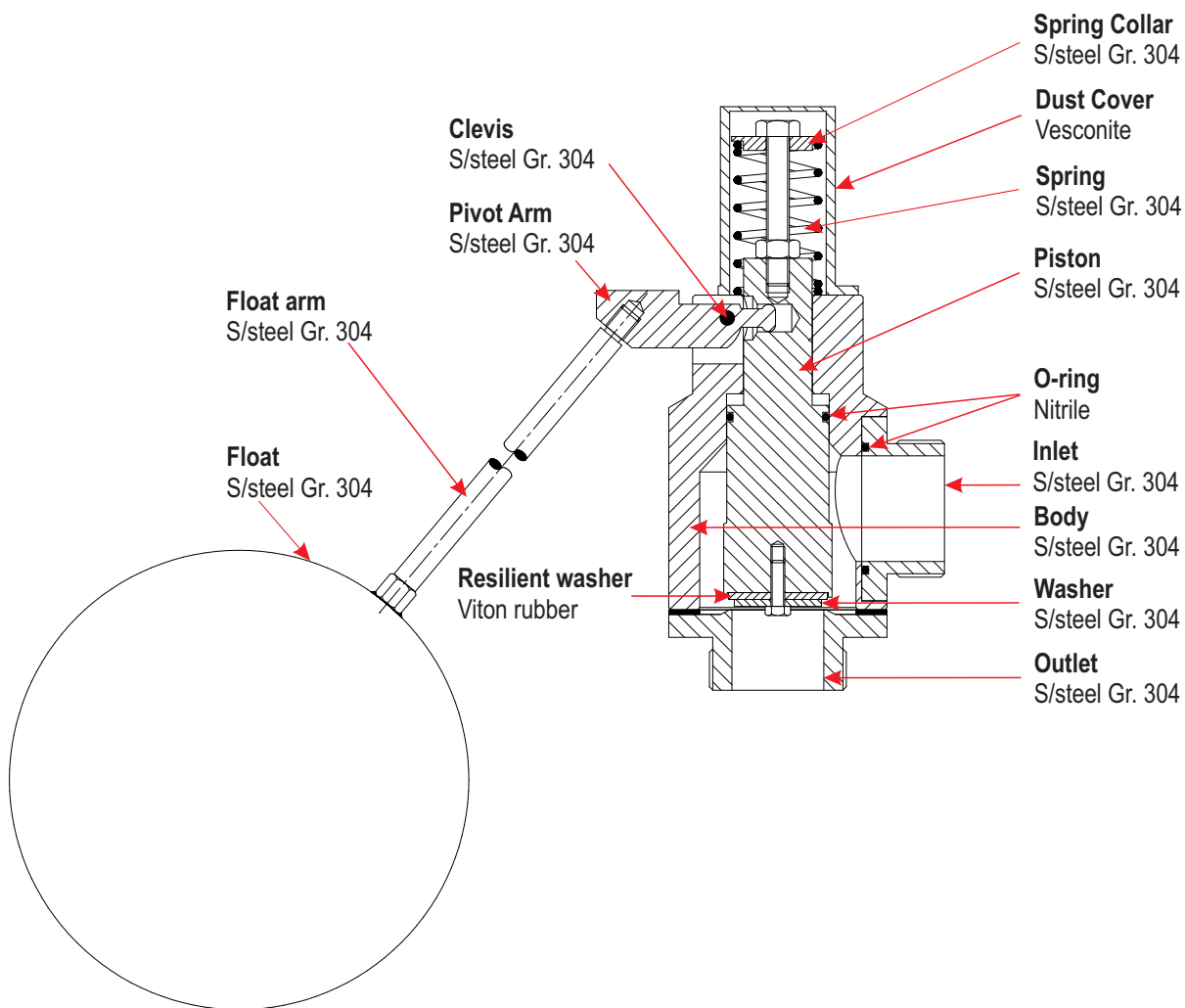



## Overall Dimensions

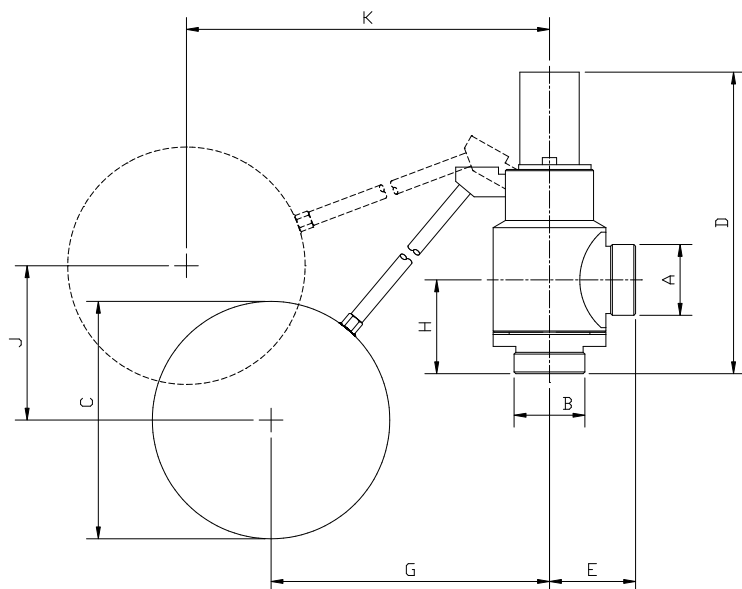

DIMENSIONS (mm)		
Size mm	40	50
A	40 BSPT	50 BSPT
B	40 BSPT	50 BSPT
C	200	200
D	254	254
E	70	70
G	305	305
H	485	485
J	240	240
K	555	555
Weight (kg)	8	8.3

## Direct Acting Float Valves Figure 7312

The Vosa Figure 7312 series valve is a direct acting float valve and can be used on clear or turbid fluids and is manufactured completely in 304 stainless steel. Suitable as a main valve or pilot on automatic control valves, similar to the Cla-Val control valve.

This valve is available in sizes 15mm to 25mm with a maximum pressure rating of 2000 kPa, and can withstand a maximum temperature of 120°C.

## Overall Dimensions

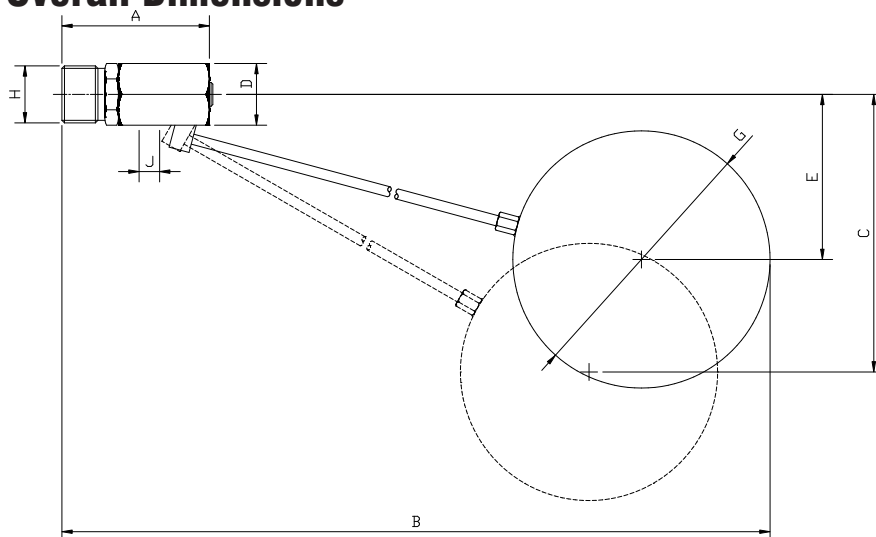

DIMENSIONS (mm)			
Size mm	15	20	25
A	86	86	86
B	470	470	610
C	180	180	260
D	30 AF	30 AF	36 AF
E	75	75	75
G	125	135	150
H	15 BSP	20 BSP	25 BSP
J (outlet)	¼" NPT	¼" NPT	¼" NPT
Weight (kg)	0.8	0.83	1



## Other DFC World Class Performance Related Valves

### Vosa Resilient Seal Valve (RSV)

Robust resilient seal gate valves designed for water, slurry and sewage applications to SANS 664 specifications

- Available in sizes from 50mm to 300mm
- All RSV's rated to PN16

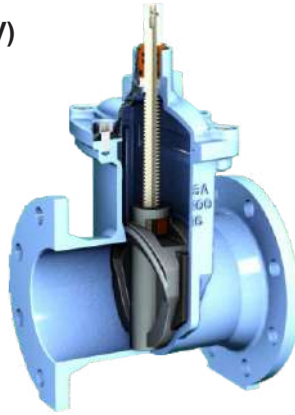

### Vosa Butterfly Valve

High performance double eccentric butterfly valves to ensure less wear on seal and lower operating torque requirements.

- Available in sizes of 80mm to 300mm
- Pressure ratings vary from PN10 to PN40

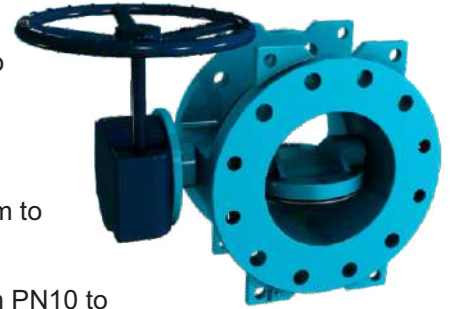

### Vosa Wedge Gate Valve

Metal seated wedge gate valves for isolation and scouring purposes and used in water, mining, power, marine and general industries

- Available sizes from DN50 to DN1200
- Pressure range vary up to 64 bar depending on the size of the required valve



### VENT-O-MAT Air Valves

Considered the world leaders in air transfer technology in water, slurry, tailings and sewage pipelines with the first ever integral "anti shock" technology for surge protection.

- RBX sizes 25mm to 200mm up to \*100 Bar
- RBXc sizes 25mm to 300mm up to 25 Bar Same as RBX but with FBE coated ductile iron bodies
- RGX sizes 50mm to 300mm up to 25 Bar
- RGXII sizes 50mm to 200mm up to 16 Bar
- RPS sizes 15mm to 50mm up to 16 Bar



### Vosa Swing Check Valve

Metal seated wedge gate valves for isolation and scouring purposes and used in water, mining, power, marine and general industries

- Available sizes from DN50 to DN400.
- Pressure range from 16 bar to 25 bar
- Available with bronze trim or all iron trim



### VENT-O-MAT Nozzle Check Valve

Characterized by "non-slam" closure, low pressure loss, metal to metal sealing and considered maintenance free.

- NCV-B (Long F/F) and NCV-BK (Short F/F) sizes DN200 - DN1200
- Pressure ratings from PN10 to PN40

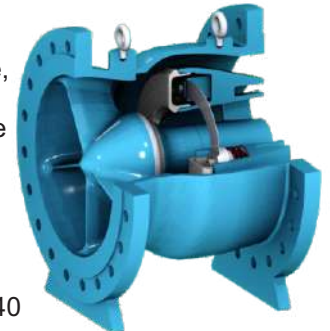

#### The Americas Operations

RF Valves Inc.  
1342-A Charwood Road  
Hanover, MD 21076, USA  
Tel: +1-410-850-4404 Fax: +1-410-850-4464  
email: [contact@rfvalve.com](mailto:contact@rfvalve.com)  
[www.rfvalve.com](http://www.rfvalve.com)

#### European Operations

RF Valves, Oy.  
Tullitie 9,  
53500 Lappeenranta, Finland  
Tel: +358-20-758-1790 Fax: +358-20-785-1799  
email: [rfvalves@rftek.fi](mailto:rfvalves@rftek.fi)  
[www.rfvalve.com](http://www.rfvalve.com)

#### African Operations

Dynamic Fluid Control (Pty) Ltd  
32 Lincoln Road,  
Industrial Sites, Benoni South, South Africa  
Tel: +27-11-748-0200 Fax: +27-11-421-2749  
email: [dfc@dfc.co.za](mailto:dfc@dfc.co.za)  
[www.dfc.co.za](http://www.dfc.co.za)

#### Brazil Operations

Industria e Comercio de Valvulas do Brasil Ltda  
Address: Rua Álvaro da Silveira, 40 - Santa Margarida  
Belo Horizonte - Minas Gerais, Brasil  
Tel : +55-31-3658-3656  
Email address: [rfq@rfvalve.com](mailto:rfq@rfvalve.com)  
[www.rfvalve.com](http://www.rfvalve.com)

#### Australian Operations - NSW

5 Vangeli St, Arndell Park, NSW, 2148  
P.O. Box 156, Seven Hills, NSW, 1730  
Tel: +61-2-8814-9699  
Fax: +61-2-8814-9666  
Email: [sales@ventomat.com.au](mailto:sales@ventomat.com.au)  
Website: [www.ventomat.com.au](http://www.ventomat.com.au)